



3801/500 Pacific Highway St Leonards, NSW

 2  2  1

## Sun drenched apartment with captivating northerly aspect

This sun-drenched generously-sized two-bedroom apartment is situated on the 38th floor with open-plan living leading out onto a massive entertainer balcony, enjoying a spectacular sunrise and sunset view.

### Home Features:

- Open plan living and dining area with access to balcony
- Wrap around balcony in perfect corner position overlooking beautiful district views of Sydney harbour
- Luxury Miele brand kitchen appliances including build-in fridge
- Two spacious north facing bedrooms with access to the wraparound balcony

**\$1,400 pw**

**Inspect** : Saturday, 20th July 2024 3:00 - 3:20

**Type** : Apartment

**Date Available** : Tuesday, 13th August 2024

**Bond** : \$5,600.00

**Faye Dai**

0423 677 160



- F Finish
- L Laundry
- P Entry
- ST Storage
- W Wardrobe

Apartment Type	2 Bedrooms
Bedrooms	2
Bathroom	1
Storage	28 sq m
Wardrobe	1

## THE LANDMARK

*Sculpted from Sydney*

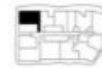

## Two Bed Apartment Type A

Disclaimer: Colliers International does not guarantee, warrant or represent that the information contained in this advertising and marketing document is correct. Any interested parties should refer their own enquiries as to the accuracy of the information. We exclude all liability or implied terms, conditions and warranties arising out of this document and you liability for loss or damage arising from them.